



Jefferson County Fair Complex

430 SW Fairgrounds Rd, Madras, OR 97741

P: 541-325-5050 - F: 541-475-2586

Rental Fee Schedule as of 2024

SUBJECT TO CHANGE WITHOUT NOTICE



CORWIN ARENA

900 Seated Capacity

90' x 200' Floor

5 Bucking Chutes

6,000 SF Bleacher Area

\$750.00 / day

\$20.00 / hour after hours (reservation required)
\$5.00 / rider Open Ride (7:00 AM to 4:30 PM, M-F)



MACCIE CONROY

200 Seated

428 Standing

3,000 Square Feet

(Includes Kitchenette)

\$550.00 / day

Combine with Keeney: \$800.00 / day

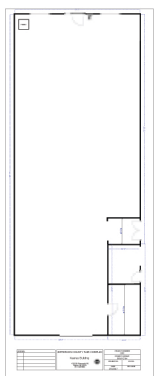
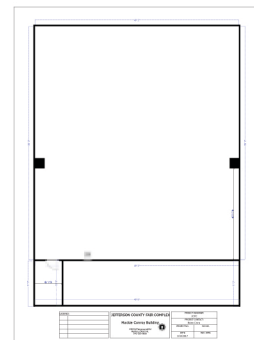

HERBERT E. KEENEY

150 Seated

300 Standing

4,000 Square Feet

\$250.00 / day

Combine with Maccie Conroy: \$800.00 / day
(Can ONLY be rented with Maccie Conroy)



JESSE DARRAR (4-H)

100 Capacity

2,400 Square Feet

(Includes Full Kitchen)

\$300.00 / day





Rental Fee Schedule

Rental Fee Schedule as of 2024

SUBJECT TO CHANGE WITHOUT NOTICE

Jefferson County Fair Complex
430 SW Fairgrounds Road, Madras, OR 97741
541-325-5050

KITCHEN / CAFE

Seats 60
1,280 Sq Ft
Refrigerators/Freezers
Ice Maker
Commercial Cooktop
\$500.00 / day*

*Special cleaning requirements



INDIAN HEAD CASINO PAVILION

300 Capacity
30 Picnic Tables
30' x 21' Stage
\$350.00 / day

OUTDOOR ARENA

135' x 350'
\$250.00 / day



WARD FARRELL SHOW BARN & ANIMAL BARN

Including areas adjacent to buildings
(Includes Integrated Sound System)
\$250.00 / day per barn



Bi-Mart SHOW BARN

Including areas adjacent to building
(Includes Integrated Sound System)
\$450.00 / day per barn



Rental Fee Schedule

Jefferson County Fair Complex
430 SW Fairgrounds Road, Madras, OR 97741
541-325-5050

Grounds Rental

North Field Rental	\$300.00/day
Homestead Field Rental (weddings/parties)	\$500.00/day

Stalls and Pens

Individual stall rental (maximum 14 days)	\$20.00/day
Outside Pens (per head)	\$20.00/day

Deposits

Refundable Key Deposit (per key)	\$100.00
Non-profit Deposit (events without alcohol or music)	\$350.00
Refundable Deposit (events without alcohol or music)	\$750.00
Refundable Deposit (events with alcohol or music, including DJ)	\$1,500.00

Additional Fees

Security (Subject to length of event, attendees and services required)	\$Varies
Premium Tables and Chairs (limited supply)	\$Varies
Tables and Chairs (limited supply)	Included with rent
Rolling Indoor Arena	\$250.00
Janitorial Services during event or cleanup (per person)	\$150.00/hr
Events requiring shavings	Shavings + Trucking
Moving of shavings for livestock event	\$250.00
Bleacher rental and placement (per bleacher)	\$250.00
Stage rental and placement	\$350.00
Rental of Portable Sound System	\$250/day + \$250 Dep.
Rental of Portable Video System	\$250/day + \$250 Dep.
Vendor space during events (per day, per vendor)	\$35.00

Insurance

Lessee shall procure and maintain throughout the term of the event liability insurance covering claims for bodily injury, death and property damage occurring in or upon or resulting from the facilities lease. Lessee shall obtain insurance in the amount of \$2,000,000 per occurrence and \$4,000,000 aggregate. Lessee shall provide a Certificate of Insurance with an additional insured endorsement naming Jefferson County, JCFC, officers, employees and agents as additional insureds. If alcohol is being served or consumed, lessee is required to have liquor liability included. Insurance policies must be written on an "occurrence" basis unless Jefferson County authorizes a "claims made" policy. Proof of insurance is required at least 60 days prior to event. Failure to provide proof of insurance will result in cancellation of your event and forfeiture of your deposit. Additionally, Lessee shall provide proof of automobile liability insurance for any transportation vehicle used on the fairgrounds for your event.

Alcohol Sales

If you sell alcohol for your event, the Fair Board has exclusive right to determine the provider and receive all sales revenue.